

Tel: 966 12 684 8046  
 966 12 684 8959  
 Fax: 966 12 640 5622  
 AFS OEJDYKYX  
<http://www.sans.com.sa>  
 E-mail: [aim@sans.com.sa](mailto:aim@sans.com.sa)

**KINGDOM OF SAUDI ARABIA**  
 GENERAL AUTHORITY OF CIVIL AVIATION  
 SAUDI AIR NAVIGATION SERVICES  
 AERONAUTICAL INFORMATION MANAGEMENT  
 P. O. BOX 929, JEDDAH - 21421

**AIP  
 SUP**  
**AIP SUP 46/25**  
 14 NOV 2025

## **DAMMAM / KING FAHD INTL AIRPORT – (OEDF) PERMANENT CHANGE TO TAXIWAY DESIGNATION**

### **1 INTRODUCTION**

This AIP Supplement promulgates a permanent change to taxiway designation at King Fahd International Airport (OEDF). The modification aims to improve standardization and clarity of ground movement routing within Apron 2 and Taxiway J.

### **2 DESCRIPTION OF CHANGE**

Effective 16 November 2025, the following permanent designation changes are implemented:

| <b>Old Designation</b>    | <b>New Designation</b> |
|---------------------------|------------------------|
| TWY J Entrance to RWY 34R | TWY J1                 |
| TWY J1                    | TWY J2                 |
| TWY J2                    | TWY J3                 |
| TWY J3                    | TWY J4                 |
| TWY J Entrance to RWY 16L | TWY J5                 |
| TWY J Entrance to APN 8   | TWY K1                 |
| TWY J3 Entrance to APN 5  | TWY K3                 |
| TWY J Entrance to APN 4   | TWY K4                 |
| TWY connecting P1 and P2  | TWY P                  |

### **3 OPERATIONAL ARRANGEMENTS**

- ATC shall apply the updated TWY designation in all instructions and clearances effective 16 NOV 2025.
- Pilots shall use the updated TWY designation in all communications with ATC.
- Ground service providers and airport operators shall ensure all internal documents reflect the updated naming.

### **4 VALIDITY**

This Supplement contains a permanent change and will remain in force until incorporated in the AIP.

### **5 ATTACHMENTS**

Updated Aerodrome Chart.

**THIS PAGE  
INTENTIONALLY  
LEFT BLANK**

**AERODROME CHART - ICAO**

26°28'16"N  
049°47'52"E

**ELEV 75**

TWR 118.05 (E) 124.35 (W)  
SMC 121.65 121.75  
ATIS 128.05

**DAMMAM / KING FAHD INTERNATIONAL**

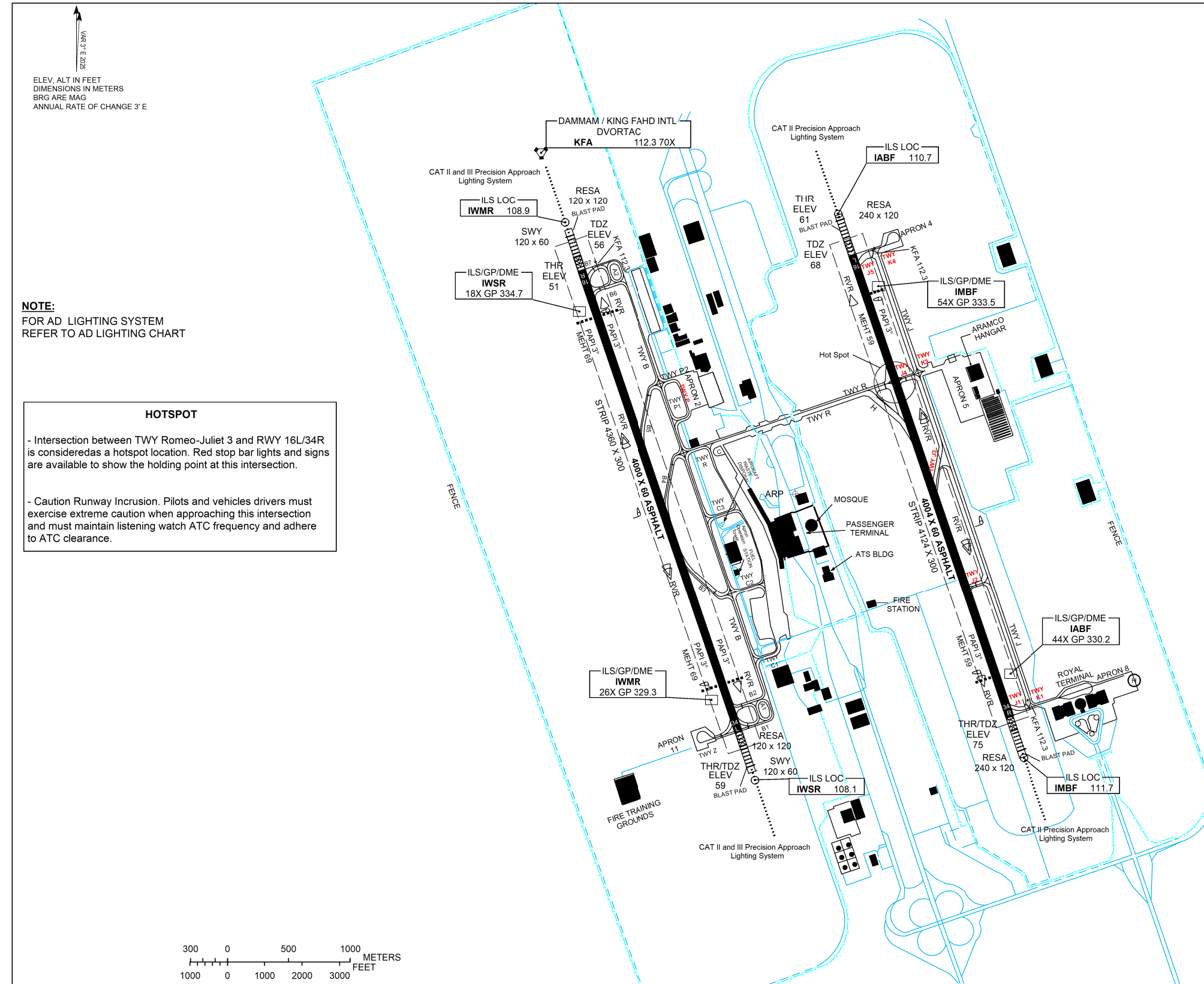

**NOTE:**  
FOR AD LIGHTING SYSTEM  
REFER TO AD LIGHTING CHART

**HOTSPOT**

- Intersection between TWY Romeo-Juliet 3 and RWY 16L/34R is considered as a hotspot location. Red stop bar lights and signs are available to show the holding point at this intersection.

- Caution Runway Incursion. Pilots and vehicles drivers must exercise extreme caution when approaching this intersection and must maintain listening watch ATC frequency and adhere to ATC clearance.

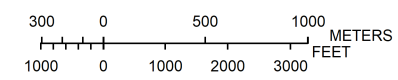

| RWY | DIRECTION | THR                       | THR GUND | BEARING STRENGTH           |
|-----|-----------|---------------------------|----------|----------------------------|
| 16L | 161°      | 26°29'19"N<br>049°48'13"E | -81      | PCN 111 F/A/X/T<br>ASPHALT |
| 34R | 341°      | 26°27'14"N<br>049°48'52"E | -81      | PCN 111 F/A/X/T<br>ASPHALT |
| 16R | 161°      | 26°29'19"N<br>049°46'53"E | -81      | PCN 120 F/A/X/T<br>ASPHALT |
| 34L | 341°      | 26°27'14"N<br>049°47'32"E | -81      | PCN 120 F/A/X/T<br>ASPHALT |

| TAXIWAY DESIGNATOR | Width | BEARING STRENGTH (PCN) | Surface  |
|--------------------|-------|------------------------|----------|
| A1                 | 28    | 111/F/A/X/T            | ASPHALT  |
| A2                 | 28    | 111/F/A/X/T            | ASPHALT  |
| B                  | 23    | 111/F/A/X/T            | ASPHALT  |
| B1                 | 33.5  | 111/F/A/X/T            | ASPHALT  |
| B2                 | 28    | 111/F/A/X/T            | ASPHALT  |
| B3                 | 28    | 111/F/A/X/T            | ASPHALT  |
| B4                 | 28    | 111/F/A/X/T            | ASPHALT  |
| B5                 | 28    | 111/F/A/X/T            | ASPHALT  |
| B6                 | 28    | 111/F/A/X/T            | ASPHALT  |
| B7                 | 33.1  | 111/F/A/X/T            | ASPHALT  |
| C                  | 28    | 103/F/A/X/T            | CONCRETE |
| C1                 | 28    | 103/F/A/X/T            | ASPHALT  |
| C2                 | 28    | 103/F/A/X/T            | ASPHALT  |
| C3                 | 28    | 103/F/A/X/T            | ASPHALT  |
| H                  | 28    | 103/F/A/X/T            | ASPHALT  |
| J                  | 23    | 103/F/A/X/T            | ASPHALT  |
| J1                 | 28    | 103/F/A/X/T            | ASPHALT  |
| J2                 | 28    | 76/F/A/X/T             | ASPHALT  |
| J3                 | 28    | 103/F/A/X/T            | ASPHALT  |
| P1                 | 28    | 103/F/A/X/T            | ASPHALT  |
| P2                 | 28    | 103/F/A/X/T            | ASPHALT  |
| R                  | 30    | 103/F/A/X/T            | ASPHALT  |
| Z                  | 28    | 111/F/A/X/T            | ASPHALT  |

| APRON    | BEARING STRENGTH (PCN) | Surface  |
|----------|------------------------|----------|
| APRON 1  | 64/R/B/X/T             | CONCRETE |
| APRON 11 | 64/R/B/X/T             | CONCRETE |
| APRON 2  | 64/R/B/X/T             | CONCRETE |
| APRON 4  | 64/R/B/X/T             | CONCRETE |
| APRON 5  | 64/R/B/X/T             | CONCRETE |
| APRON 8  | 64/R/B/X/T             | CONCRETE |

| LEGEND                        |  |
|-------------------------------|--|
| RWY VISUAL RANGE (RVR)        |  |
| WIND DIRECTION INDICATOR      |  |
| HELIPAD                       |  |
| SERVICE ROAD                  |  |
| FENCE                         |  |
| HOTSPOT                       |  |
| VOR CHECK-POINT               |  |
| INTERMEDIATE HOLDING POSITION |  |
| HOLDING POSITION (PATTERN A)  |  |